

Warranty

Whilst every Lucent product is manufactured to the highest quality standards, we offer a comprehensive Warranty for complete peace of mind.

Residential Use		Commercial Use	
20 Years	Replacement Cartridge	15 Years	Replacement Cartridge
10 Years	Replacement products or parts	7 Years	Replacement products or parts
2 Year	Labour	1 Year	Labour

Warranty may become void due to any of the following:

- Inability to provide proof of purchase or equivalent documentation
- Product not installed by a licensed Plumber
- Failure to install product to national standards and state regulations
- Failure to install product in accordance with manufacturers installation instructions
- Pressure and Temperature Requirements:
 - Static inlet pressure range: 150 to 500kPa
 - Maximum hot water temperature 75 degree celsius
 - Recommended operation temperatures: 1 – 75 degrees celsius
- Fitting of non-approved flow controllers in tap bodies or outlets
- If products are used for outdoor applications.
- Product used for non-potable water applications.
- Damage because of insufficient flushing of lines prior to installation. Service, repairs, or installation of non-Lucent replacement parts undertaken without Lucent's prior written approval.
- Damage to finishes caused by non adherence to cleaning instructions.

LUCENT[®]

Installation and Operating Instructions

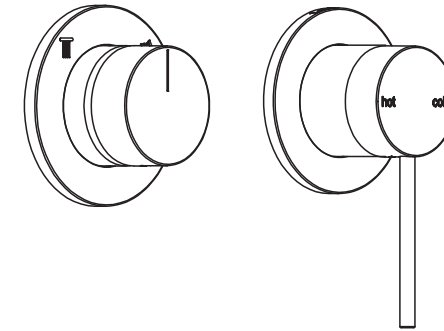

Cleaning Instructions:



CLEAN MICROFIBRE
CLOTH



SOAPY WATER



PH BALANCE
SOAP - BASED
CLEANSER

SHOWER / WALL MIXER WITH DIVERTER KIT

9980 | 9981 | 9982 | 9983 | 9984 Range

Note: Handle style may vary



Warranty Service

For all warranty service calls please contact your local store.
Phone: 1300 474 714
E-mail: warranty@lucentdesigns.com.au



Thank you for purchasing a quality Lucent product. Please note that this product must be installed by a qualified and registered plumber who is compliant with all the relevant regional requirements and who holds current certification.

Note: Please read all instructions prior to installation to limit warranty disputes should a claim arise.

Installation Instructions

Note to Plumber: Please provide this leaflet to the owner after installation.

STEP 1

Remove protective covers from the mixer and Diverter.

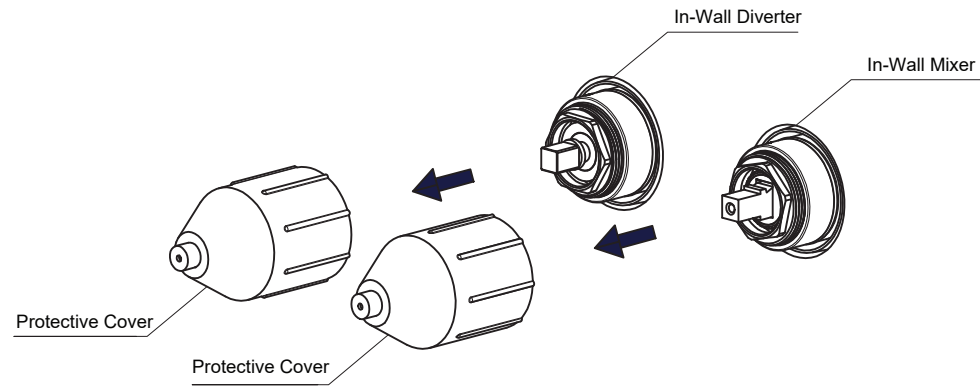

STEP 2

Insert Mixer Cover onto Mixer until it stops, then screw clockwise until hand tight.
Repeat with Diverter Cover.

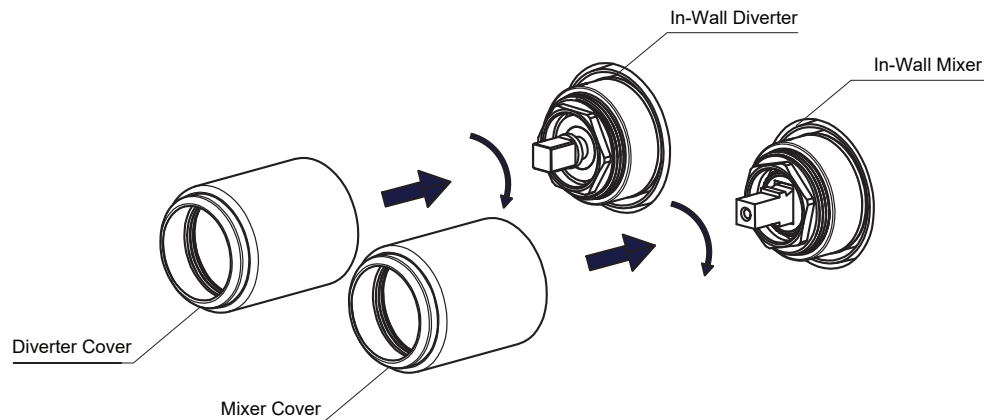

STEP 3

Gently slide the Wall Plates onto the Mixer and Diverter Covers.

Note: Diverter plates have etched markings, the mixer cover does not.

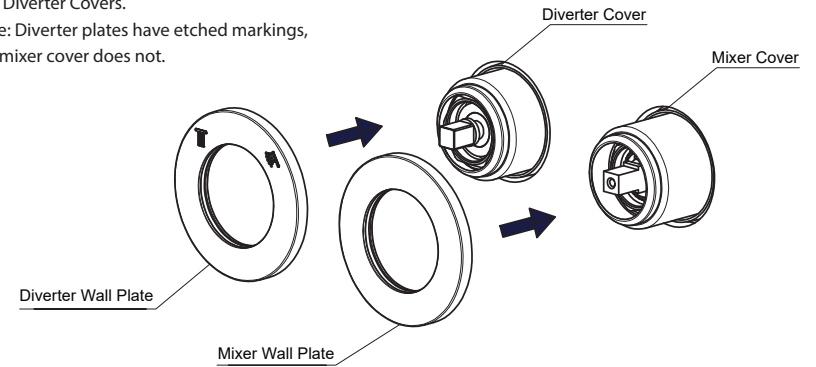

STEP 4

Attach diverter handle onto the body, ensuring alignment with wall plate identifiers and tighten with the hex key provided.

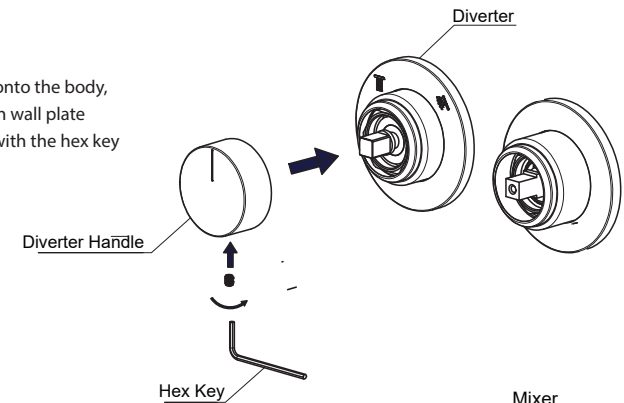

STEP 5

Ensure correct alignment of handle and install handle onto the Mixer Cartridge. Secure using the provided Hex Key.

